

EzyFit Insertable Damper

EzyFIT: Foldable Insertable Technology

You can now overcome applications in which you do not have access to duct work with the proven retrofit technology of the EzyFit damper. The EzyFit installs directly through the register boot, making zoning retrofit jobs simple and easy.

The compact, folded design allows you to slip the damper in through the register while magnets set it firmly in place. The gasketed blade shuts off airflow for minimal air flow leaks. The EzyFit ensures quiet operation with the tight seal of the gasket material, eliminating noisy whistling.



Contractor Benefits

- Significantly reduces labor time and cost
- Easy installation: fold, slide in, release and run tubing
- Creates less turbulence in the register boot
- Can be mix and matched with other EzySlide dampers on a system
- Opens new sales opportunities for applications with no access to duct work

Consumer Benefits

- Quiet operation, no whistling or squeaking of blades
- Enjoy enhanced comfort in areas with no access to duct work
- No reconstruction of duct work
- No messy installation
- Quick installation allows for immediate comfort enhancement

Product Specifications

Available Sizes

- Available in 5", 6" and 7"

Installation Specifications

Fits easily in:

- Boot - end, angled or straight
- Any type of metal duct work: horizontal or vertical



Installation Instructions

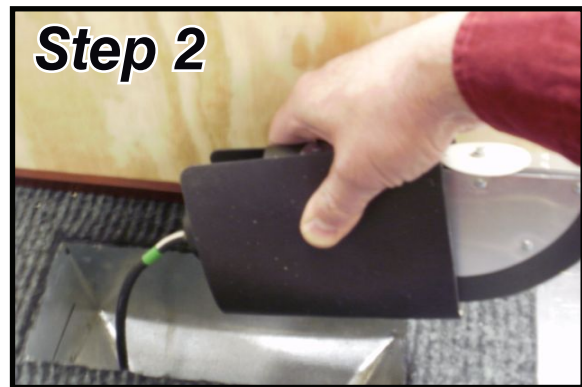

Installation Instructions

1. Run tubing from register to panel
2. Connect tubing to damper.
3. Fold blade first, then fold magnet around the blade
4. Insert damper through the boot-tubed end first. Ensure the blade is past any sheet metal screws holding the boot to the branch run and release blade.
5. Settle the magnet against the inside of the duct. Ensure magnet is adhered completely to inside of duct.
6. Cycle the blade several times to ensure clear movement and good magnet seating.